

WORK IN RIGHT SIDE AT  
 INTERSECTION OF ONE-WAY STREET AND TWO-WAY STREET  
 PLAN 22B2TOW

Location \_\_\_\_\_

USE THIS PLAN FOR ALTERNATING  
 ONE WAY TRAFFIC WHEN THE  
 UNOBSTRUCTED ROADWAY AREA  
 OUTSIDE THE WORK ZONE IS LESS  
 THAN TWENTY FEET WIDE.

\* - OPTIONAL

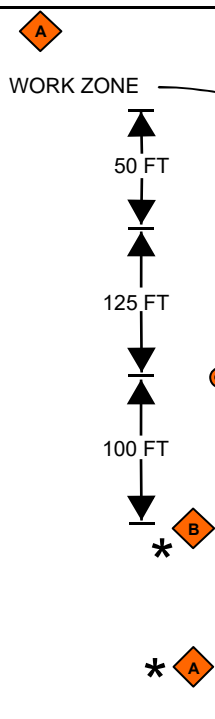
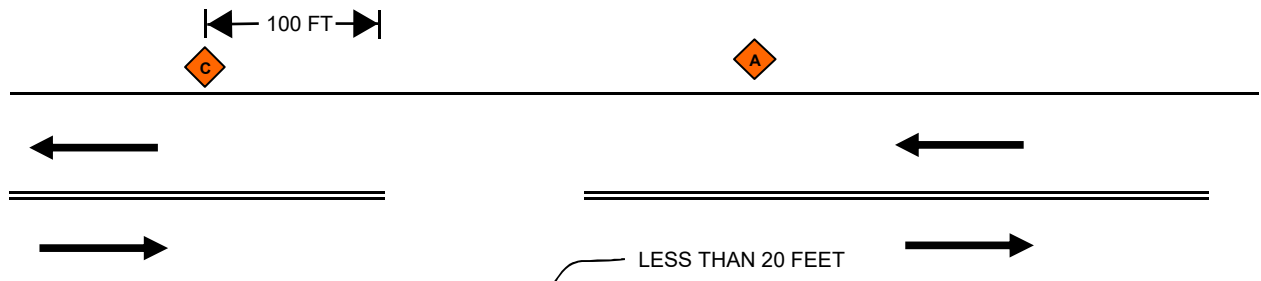

◆ QTY	LEGEND	SIZE	MUTCD	CDOT*
A 4	ROAD WORK AHEAD	36"X36"	W20-1	80-9603
B 2	ROAD NARROWS	36"X36"	W5-1	41-4492
C 2	END ROAD WORK	36"X18"	G20-2	80-9611

\* CDOT catalogue numbers are for reference only  
 Sizes may vary

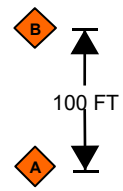

DRUM/CONE SPACING: 25 FT

SIGNS: PER SPECIFICATION OF THE M.U.T.C.D.  
 WARNING SIGNS SHALL HAVE FLORESCENT  
 ORANGE SHEETING WHERE REQUIRED.

ROADWAY CLOSURE PROHIBITED

NTS

- DENOTES TRAFFIC DRUM OR TRAFFIC CONE - MIN. HT. 28"
- ◆ DENOTES TRAFFIC SIGN
- ▨ DENOTES TYPE III BARRIER